

Miscellaneous Fittings and Materials

Illustrated in this section are the numerous items and materials so necessary to the organ builder.

Where the parts are manufactured, this is carried out to the same high standards required with our electrical equipment.

Where materials are held for resale, these are subject to the same quality procedures as our own manufacturing stock.

Illustrated are some items which are mainly for use with tracker action, but do have uses in other areas. As these are not part of the KA Tracker system they are included in this section for clarity.

Overleaf is a useful dimensional conversion chart specially devised for the KA Range of products.

Conversion chart

Standard Wire Gauge	INCHES		M/M		INCHES		M/M
	FR	DEC.			FR	DEC.	
	1/64	.015625	.397		7/16	.4375	11.113
	1/32	.03125	.794		29/64	.453125	11.51
20g		.036	.92		15/32	.46875	11.906
19g		.040	1.02		31/64	.484375	12.303
	3/64	.046875	1.191		1/2	.5	12.700
18g		.048	1.22		33/64	.515625	13.097
17g		.056	1.42		17/32	.53125	13.494
	1/16	.0625	1.587		35/64	.546875	13.891
16g		.064	1.63		9/16	.5625	14.288
15g		.072	1.83		37/64	.578125	14.684
	5/64	.078125	1.984		19/32	.59375	15.081
14g		.080	2.03		39/64	.609375	15.478
13g		.092	2.34		5/8	.625	15.875
	3/32	.09375	2.381		41/64	.640625	16.272
12g		.104	2.64		21/32	.65625	16.669
	7/64	.109375	2.778		43/64	.671875	17.066
11g		.116	2.95		11/16	.6875	17.463
	1/8	.125	3.175		45/64	.703125	17.860
10g		.128	3.25		23/32	.71875	18.256
	9/64	.140625	3.572		47/64	.734375	18.653
	5/32	.15625	3.969		3/4	.75	19.050
	11/64	.171875	4.366		49/64	.765625	19.447
	3/16	.1875	4.763		25/32	.78125	19.844
	13/64	.203125	5.159		51/64	.796875	20.241
	7/32	.21875	5.556		13/16	.8125	20.638
	15/64	.234375	5.953		53/64	.828125	21.035
	1/4	.25	6.35		27/32	.84375	21.432
	17/64	.265625	6.747		55/64	.859375	21.828
	9/32	.28125	7.144		7/8	.875	22.225
	19/64	.296875	7.541		57/64	.8906	22.622
	5/16	.3125	7.938		29/32	.90625	23.019
	21/64	.328125	8.334		59/64	.921875	23.416
	11/32	.34375	8.731		15/16	.9375	23.813
	23/64	.359375	9.128		61/64	.953125	24.210
	3/8	.375	9.525		31/32	.96875	24.607
	25/64	.390625	9.922		63/64	.984375	25.004
	13/32	.40625	10.319		1	1.0	25.401
	27/64	.421875	10.716				

Leather Buttons

These buttons are manufactured by KA from specially selected close grained leather.

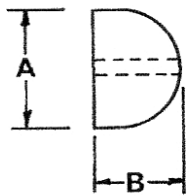

	A	B
Med.	$5\frac{1}{16}$	$7\frac{1}{32}$
Small	$7\frac{1}{32}$	$5\frac{1}{32}$

Order Details	Ref	Code
Medium Buttons 15g hole	LBM/15	FS264
Medium Buttons 16g hole	LBM/16	FS265
Medium Buttons 17g hole	LBM/17	FS266
Small Buttons 15g hole	LBS/15	FS267
Small Buttons 16g hole	LBS/16	FS268
Small Buttons 17g hole	LBS/17	FS269

Plastic Buttons

These buttons are consistent in size and manufactured from high grade polypropylene. To aid assembly they have a finger grip moulded around the top diameter.

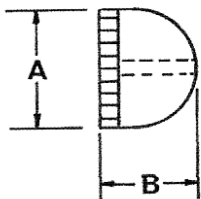

	A	B
Large	$3\frac{3}{8}$	$1\frac{1}{4}$
Med.	$5\frac{1}{16}$	$7\frac{1}{32}$
Small	$7\frac{1}{32}$	$5\frac{1}{32}$

Order Details	Ref	Code
Large Buttons 16g hole	PBL/16	FS272
Medium Buttons 15g hole	PBM/15	FS273
Medium Buttons 16g hole	PBM/16	FS274
Medium Buttons 17g hole	PBM/17	FS275
Small Buttons 16g hole	PBS/16	FS276

Red Cloth Washers

Cut from the finest red cloth with proven service in all manner of applications. Now available in 2 sizes

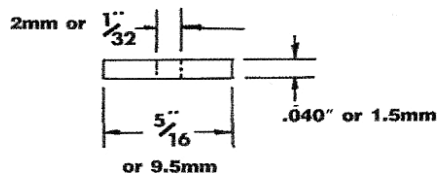

Order Details	Ref	Code
Red Cloth washers 8mm	RCW/1	FS277
Red Cloth Washers 9.5mm	RCW/2	FS279

Music Desk Hooks

These give a very attractive appearance to the music desk. Manufactured from quality brass rod, flattened and formed to a pleasing curve. The ends are thread rolled for maximum strength.



Order Details	Code
Book Holder Lacquered Brass	FS429

Note: antique bronze and chrome finish book holders are no longer available due to lack of demand.

Bushed Pull Down Wires

Made from phosphor bronze wire with a plastic bush fitted to the eyed end. The bush has a nominal .040" dia hole suitable for drilling out as required. Overall length is 9" to suit all applications.

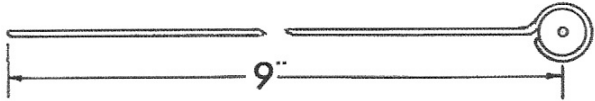

Order Details	Ref	Code
Bushed Pulldown Wires 16g	BPD/16	FS284
Bushed Pulldown Wires 17g	BPD/17	FS285
Bushed Pulldown Wires 18g	BPD/18	FS286
Bushed Pulldown Wires 19g	BPD/19	FS287

Bushed Eyes

These are a standard screwed steel eye, fitted with the same bush as the pulldown wires. Has many uses and is convenient to use.

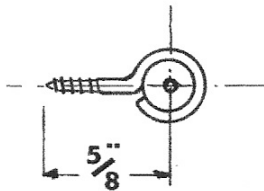

Order Details	Ref	Code
Bushed Eye	BE	FS288

Sound Board Bushes

Intended for use as guide for pulldown wires. However they have many uses and the .040" dia hole may be drilled out for other applications.

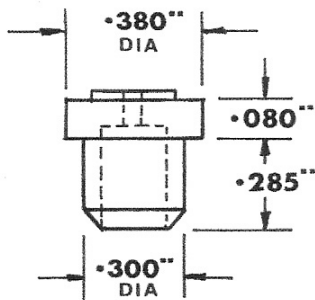

Order Details	Ref	Code
Sound Board Bushes	SBB	FS289

Tracker Wires

These are made in 16swg phosphor bronze wire with a thread at one end.

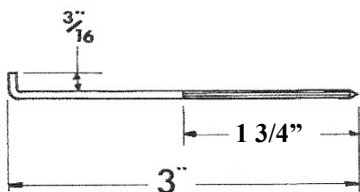

Order Details	Ref	Code
16g Tracker Wires	TW	FS290

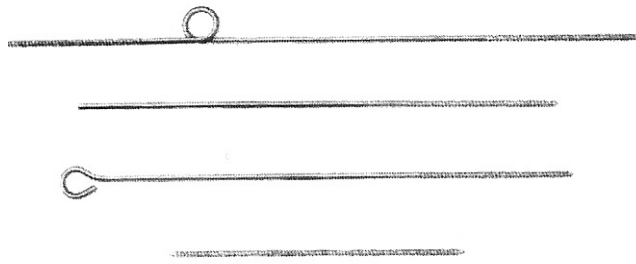

Tapped Wires

Kimber-Allen are fully equipped to supply special phosphor bronze tapped wires, to samples or drawings. Details of this option on request.

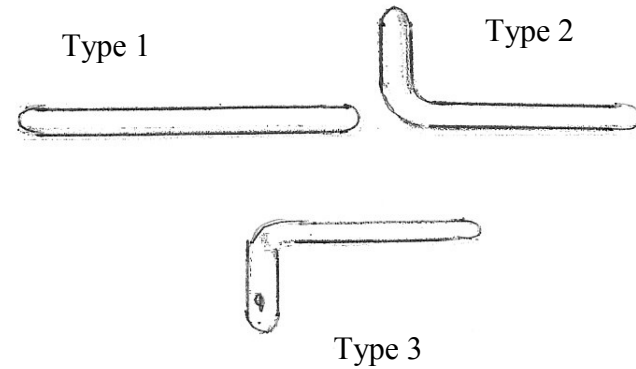

Centres

Three types of steel centres are available as illustrated. They are bright zinc plated, an ideal medium for their particular use.

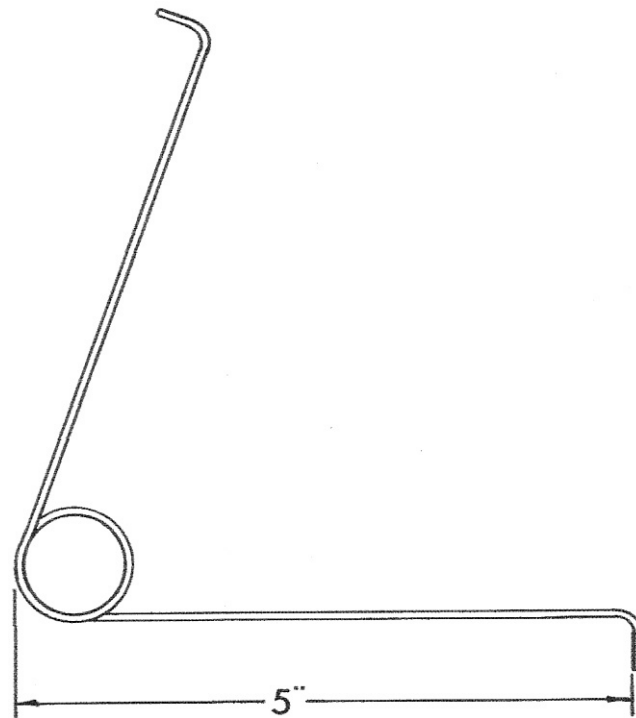

Order Details

Code

Type No.1,	3" X 1/4" dia	FS292
Type No.1,	2 1/2" X 1/4" dia	FS293
Type No.1,	2" X 3 3/16" dia	FS294
Type No.1,	2" X 5/32" dia	FS295
Type No.2,	1 5/16" X 1/2"	
	X 3/16" dia	FS296
Type No.2,	1 5/16" X 1/2"	
	X 5/32" dia	FS297
Type No.3,	1 5/16" X 1/2"	
	X 3/16" dia	FS298
Type No.3,	1 5/16" X 1/2"	
	X 5/32" dia	FS299

Pallet Springs

Three gauge sizes are available to accommodate a wide range of applications. All have 5" long straight legs, with a small gap between the spring coils to prevent unwanted noise in operation. The quality spring steel wire is bright zinc plated for protection against corrosion.

Order Details

Ref

Code

Pallet Springs 16g	PS16	FS308
Pallet Springs 17g	PS17	FS309
Pallet Springs 18g	PS18	FS310

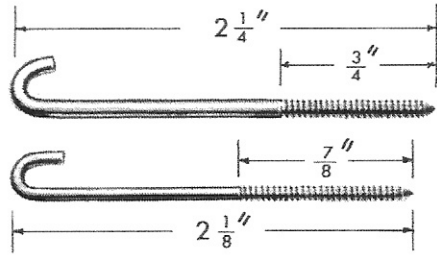

Key Hooks

To cover all requirements two types and diameters are available. They are manufactured in quality Phosphor Bronze.

Order Details	Ref	Code
Key Hooks 12g	KH 12	FS311
Key Hooks 14g	KH 14	FS312

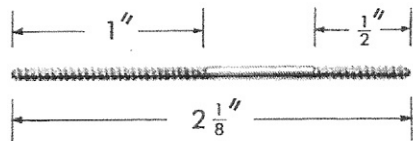

Key Check Wires

These are manufactured from 15 gauge quality Phosphor Bronze. The threads at each end are roll formed to provide extra strength.

Order Details	Ref	Code
Key Check Wires 15g	KCW	FS313

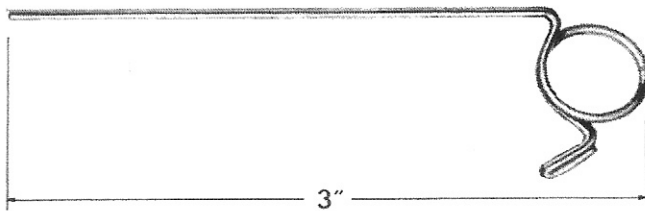

Rear Key Springs

Manufactured from quality 18 gauge spring steel wire and heavily plated for protection against corrosion.

Order Details	Ref	Code
Rear Key Springs 18g	RKS	FS333



Pointed Pins

A range of Phosphor Bronze Pointed Pins are available in various diameters and lengths to cover all requirements.

Order Details

Pointed Pins	Code
1 1/4" x 16g	FS314
1 1/2" x 12g	FS315
1 3/4" x 13g	FS316
2 1/4" x 17g	FS317
2 3/8" x 18g	FS318
3 1/2" x 17g	FS319

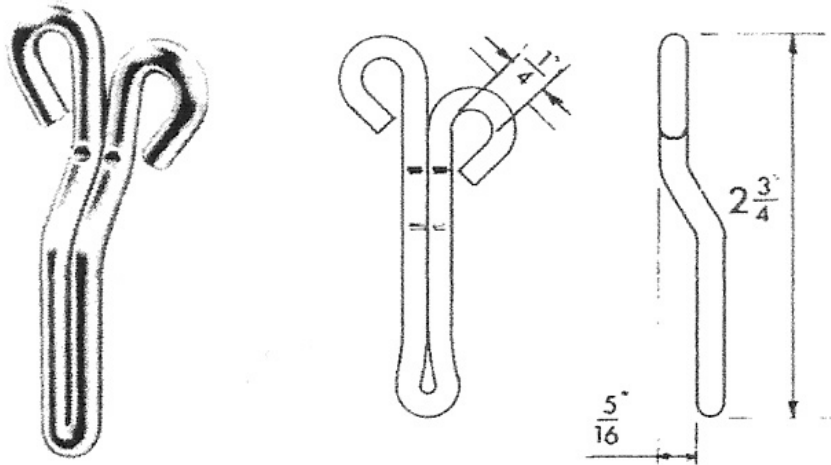

Pipe Hooks

Robust design and manufactured from 3/16" dia steel rod and bright zinc plated for permanent protection.

Order Details

Ref Code

Pipe Hooks

MPH FS369

Pedal Toe Springs

Manufactured in 10 gauge spring steel and specially heat treated to give correct touch weight to the pedal board keys. They are bright zinc electro plated for full protection against corrosion.

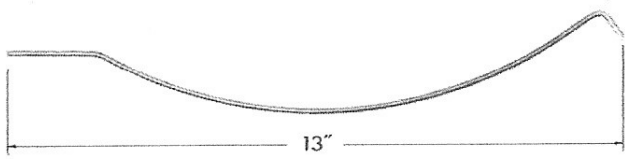

Order Details	Ref	Code
Pedal Toe Springs	PTS	FS340

Pedal Heel Springs

These are manufactured from 3/4" wide 1/8" thick spring steel which is fully heat treated to give correct spring tension. They are bright zinc plated for full protection against corrosion. Holes are 3/16" dia.

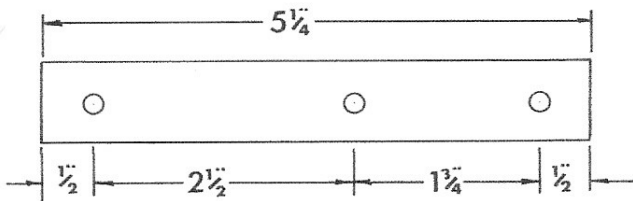

Order Details	Ref	Code
Pedal Heel Springs	PHS	FS341

Pedal Heel Plates

These are manufactured from 5/8" wide x 1/16" thick steel plate. Bright zinc plated for full protection against corrosion. Holes are 5/32" dia.

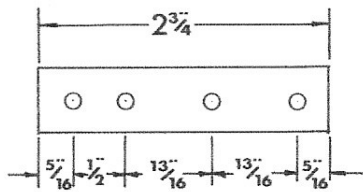

Order Details	Ref	Code
Pedal Heel Plate	PHP	FS342

Pedal End Wires and Buttons

A special eyed wire in 3/16" dia nickel plated steel which has a long thread to fit on pedal ends. Ample adjustment is possible to get correct depth of touch. A moulded button fits the thread and has a felt disc for silent operation.

The wire and button are supplied separately but illustrated assembled for clarity.

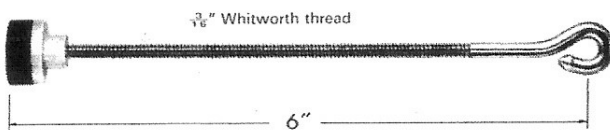

Order Details	Ref	Code
Pedal End Wire	PEW	FS343
Pedal End Button	PEB	FS344

Reed Tuning Wires

The K-A range of Reed Tuning Wires are made of phosphor bronze wire in various gauges to suit all requirements.

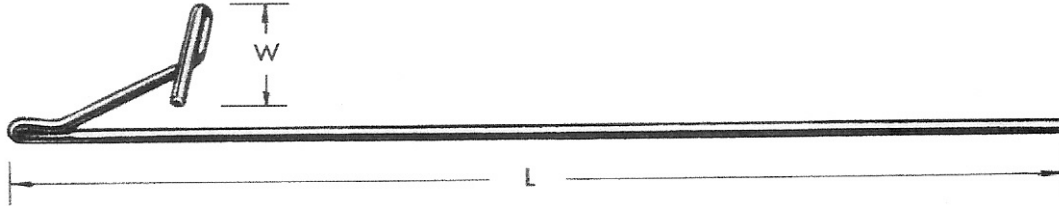

Order Details

Gauge	L	W	Ref	Code
18	4 1/2"	1/2"	RTW/18	FS350
17	4 1/2"	9/16"	RTW/17	FS351
16	4 3/4"	5/8"	RTW/16	FS352
15	5 1/4"	11/16"	RTW/15	FS353
14	5 3/4"	3/4"	RTW/14	FS354
13	6 1/2"	7/8"	RTW/13	FS355
12	7 1/2"	1"	RTW/12	FS356
11	9"	1 1/8"	RTW/11	FS357
10	1/2"	1 1/4"	RTW/10	FS358

Reed Wedges

These are solid mouldings in quality ivory White Cicolac. They are extremely tough and designed to give permanent service.

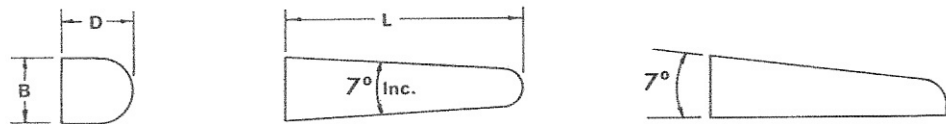

	L	B	D	Order Details	Ref	Code
Reed Wedge No.1	.812"	.175"	.153"	Reed Wedge No.1	RW1	FS359
Reed Wedge No.2	.913"	.201"	.175"	Reed Wedge No.2	RW2	FS360
Reed Wedge No.3	1.027"	.232"	.201"	Reed Wedge No.3	RW3	FS361
Reed Wedge No.4	1.156"	.266"	.232"	Reed Wedge No.4	RW4	FS362
Reed Wedge No.5	1.300"	.306"	.266"	Reed Wedge No.5	RW5	FS363
Reed Wedge No.6	1.462"	.352"	.306"	Reed Wedge No.6	RW6	FS364
Reed Wedge No.7	1.645"	.405"	.352"	Reed Wedge No.7	RW7	FS365
Reed Wedge No.8	1.850"	.465"	.405"	Reed Wedge No.8	RW8	FS366
Reed Wedge No.9	2.081"	.535"	.465"	Reed Wedge No.9	RW9	FS367
Reed Wedge No.10	2.342"	.615"	.535"	Reed Wedge No.10	RW10	FS368

Boxes of Reed Wedges available.

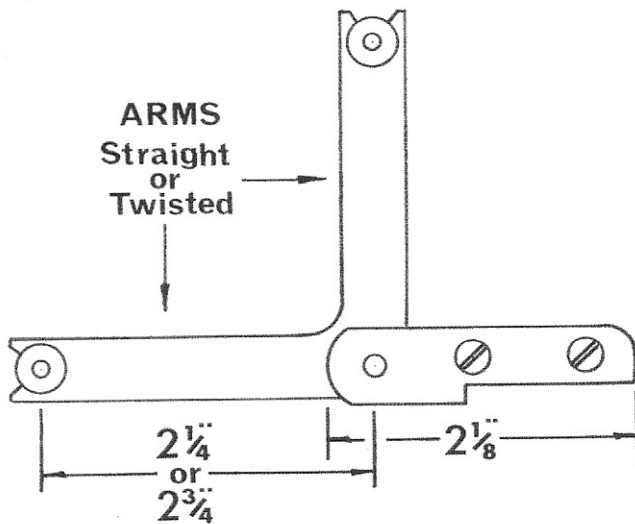

Aluminium Squares

These are an original K-A design with the heavy action In mind. The base is a tough moulded block into which a stout pivot is secured. This gives the aluminium square a perfect movement without side play or lost motion. Two sizes are available and can be supplied with the legs straight or twisted. Each is fitted with a K-A action bush. These requirements to be stated with your order. Please note these are not part of the K-A Mechanical Action system.

Order Details

Code

2 1/4" Aluminium Square	AS375
2 3/4" Aluminium Square	AS376

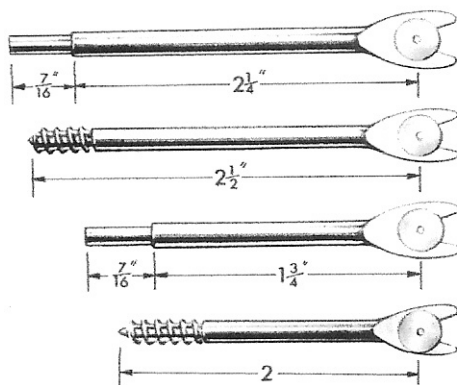

Roller Arms

These follow the original design of Roller Arms, and are not part of the K-A Mechanical Action System. Plain and screwed types are available each in two lengths. The steel arms are bright zinc plated and the flattened end has a K-A action bush fitted which can be drilled out as required.

Order Details

Code

Roller Arm 2 1/4" Plain	FS382
Roller Arm 1 3/4" Plain	FS383
Roller Arm 2" threaded	FS384
Roller Arm 2 1/2" threaded	FS385

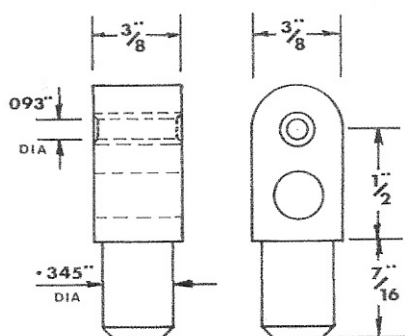

Roller Board Studs

The black body is a tough moulded construction and is fitted with a P.T.F.E. bearing insert which is permanently heat sealed into position. This arrangement gives a frictionless bearing to roller spindles.

Order Details

Code

Roller Board Stud	FS381
-------------------	-------

Flexible Tubing

To cover all requirements in the distribution of wind, a range of strong flexible tubing is always available. It has a metal spring and a special proofed paper construction. It can be bent without distortion and be easily cut to length.

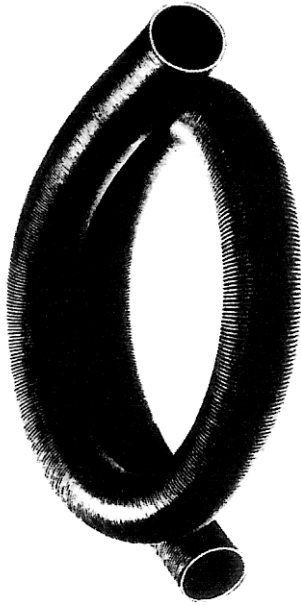

Order Details

Code

Flexible Tubing 1/2"	FS400
Flexible Tubing 3/4"	FS401
Flexible Tubing 1"	FS402
Flexible Tubing 1 1/2"	FS404
Flexible Tubing 2"	FS406
Flexible Tubing 2 1/2"	FS407
Flexible Tubing 3"	FS408
Flexible Tubing 3 1/2"	FS409
Flexible Tubing 4"	FS410
Flexible Tubing 5"	FS411
Flexible Tubing 6"	FS412

Please note the sizes given above are the approximate inside diameter.

Plastic Tubing

Manufactured in red P.V.C plastic which ensures that it will remain pliable and give lasting service. For the many requirements of smaller diameter tubing this is an excellent choice.

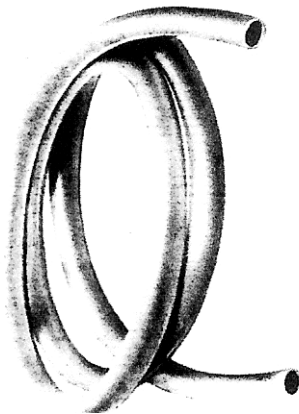

Order Details

Code

Red Plastic Tubing 1/4"	FS414
Red Plastic Tubing 5/16"	FS415
Red Plastic Tubing 3/8"	FS416

Please note the sizes given above are the approximate inside diameter.

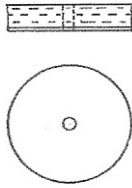

Pallets

Two types of pallets are available, both in a wide range of diameters to suit all applications. Details of the Pallets intended for use with the K-A range of Direct Pallet Magnets, can be found on page 24. They are a bonded assembly of red fibre board backing, with a green felt and quality chrome leather facing.

Felt and Leather Pallets

Here we list our range of bonded green felt and quality chrome leather Pallets. This without the backing disc allows the user a wide choice of application. There is a 14 gauge centre hole in the pallet.

Order Details	Ref	Code
Felt & Leather Pallet 3/4"	FLP	AS431
Felt & Leather Pallet 7/8"	FLP	AS432
Felt & Leather Pallet 1"	FLP	AS433
Felt & Leather Pallet 1 1/8"	FLP	AS434
Felt & Leather Pallet 1 1/4"	FLP	AS435

Order Details	Ref	Code
Felt & Leather Pallet 1 3/8"	FLP	AS436
Felt & Leather Pallet 1 1/2"	FLP	AS437
Felt & Leather Pallet 1 3/4"	FLP	AS439
Felt & Leather Pallet 2"	FLP	AS441
Felt & Leather Pallet 2 1/2"	FLP	AS443

Fibreboard and Millboard Valves

There is a choice of material used to manufacture the backing disc of these valves. Either red fibreboard or grey millboard. The backing disc is bonded to the green felt and leather facing with a 14 gauge centre hole. Red fibreboard will be supplied if a choice is not stated with your order.

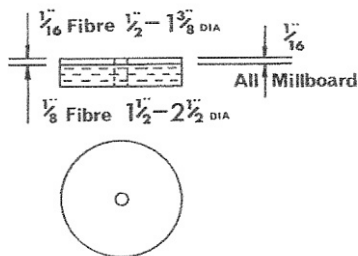

Note: See note on page 48 concerning millboard.

Order Details	Ref	Code
Fibreboard or Millboard Valve 1/2" dia	FMV	AS444
Fibreboard or Millboard Valve 5/8" dia.	FMV	AS445
Fibreboard or Millboard Valve 3/4" dia.	FMV	AS446
Fibreboard or Millboard Valve 7/8" dia.	FMV	AS447
Fibreboard or Millboard Valve 1" dia.	FMV	AS448

Order Details	Ref	Code
Fibreboard or Millboard Valve 1 1/8" dia.	FMV	AS449
Fibreboard or Millboard Valve 1 1/4" dia.	FMV	AS450
Fibreboard or Millboard Valve 1 3/8" dia.	FMV	AS451
Fibreboard or Millboard Valve 1 1/2" dia.	FMV	AS452
Fibreboard or Millboard Valve 1 3/4" dia	FMV	AS454
Fibreboard or Millboard Valve 2 " dia.	FMV	AS456
Fibreboard or Millboard Valve 2 1/2" dia.	FMV	AS458

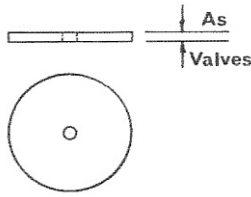

Fibreboard and Millboard Discs

The red fibreboard and grey millboard discs used in the manufacture of the K-A range of valves, can be purchased as a separate item. These discs are a useful accessory with many and varied applications.

Note: Grey millboard is becoming increasingly difficult to obtain and as such all discs may not be available in this material.

Order Details Ref Code

Fibreboard or Millboard Disc 1/2" dia	FMD AS459
Fibreboard or Millboard Disc 5/8" dia	FMD AS460
Fibreboard or Millboard Disc 3/4" dia	FMD AS461
Fibreboard or Millboard Disc 7/8" dia	FMD AS462
Fibreboard or Millboard Disc 1" dia	FMD AS463
Fibreboard or Millboard Disc 1 1/8" dia	FMD AS464

Order Details Ref Code

Fibreboard or Millboard Disc 1 1/4" dia	FMD AS465
Fibreboard or Millboard Disc 1 3/8" dia	FMD AS466
Fibreboard or Millboard Disc 1 1/2" dia	FMD AS467
Fibreboard or Millboard Disc 1 3/4" dia	FMD AS469
Fibreboard or Millboard Disc 2" dia	FMD AS471
Fibreboard or Millboard Disc 2 1/2" dia	FMD AS473

Pedal Pipe Feet

The K-A range of Pedal Pipe Feet are accurately machined in prime Beech or Birch Wood. They are left in their natural condition with a smooth finish.

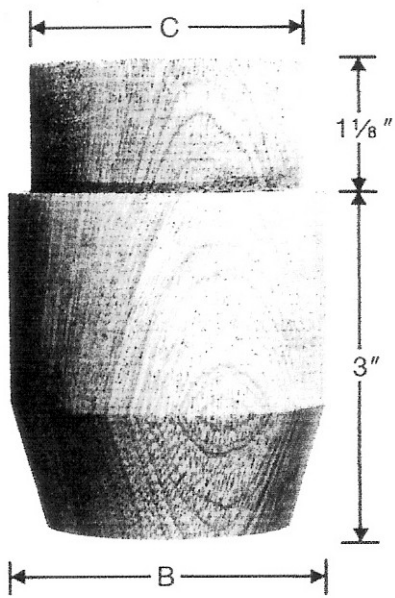

Order Details	B	C	Code
Pedal Pipe Feet 3/4" bore	1 3/8"	1 1/8"	FS484
Pedal Pipe Feet 1" bore	1 3/4"	1 7/16"	FS486
Pedal Pipe Feet 1 1/4" bore	2"	1 3/4"	FS488
Pedal Pipe Feet 1 1/2" bore	2 7/16"	2 1/16"	FS489
Pedal Pipe Feet 1 3/4" bore	2 3/4"	2 3/8"	FS490
Pedal Pipe Feet 2" bore	3 3/16"	2 5/8"	FS491

Standard Pipe Feet

These are also in prime Beech or Birch and have the same accurate machining and finish as the Pedal Pipe Feet.

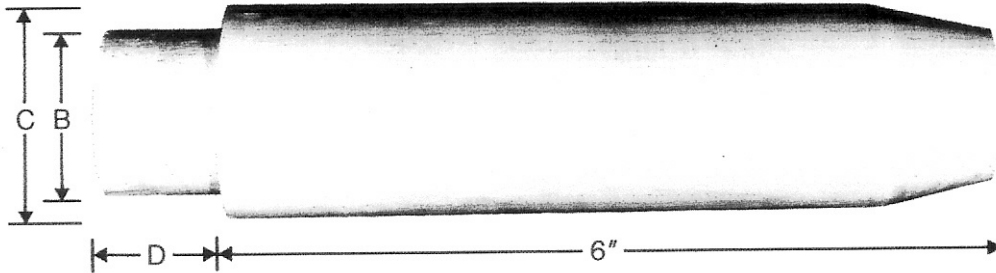

Order Details	B	C	D	Order Details	B	C	D
Standard Pipe Feet 3/16" bore	3/8"	1/2"	5/8"	Standard Pipe Feet 7/8" bore	1 1/4"	1 9/16"	1"
Standard Pipe Feet 1/4" bore	7/16"	9/16"	11/16"	Standard Pipe Feet 1" bore	1 3/8"	1 3/4"	1"
Standard Pipe Feet 5/16" bore	9/16"	3/4"	7/8"	Order Details			Code
Standard Pipe Feet 3/8" bore	5/8"	27/32"	7/8"	Standard Pipe Feet 3/16" bore			FS499
Standard Pipe Feet 1/2" bore	3/4"	31/32"	7/8"	Standard Pipe Feet 1/4" bore			FS500
Standard Pipe Feet 5/8" bore	15/16"	1 1/8"	7/8"	Standard Pipe Feet 5/16" bore			FS502
Standard Pipe Feet 3/4" bore	1 1/16"	1 5/16"	1"	Standard Pipe Feet 3/8" bore			FS503
				Standard Pipe Feet 1/2" bore			FS505
				Standard Pipe Feet 5/8" bore			FS506
				Standard Pipe Feet 3/4" bore			FS507
				Standard Pipe Feet 7/8" bore			FS508
				Standard Pipe Feet 1" bore			FS509

Stopper Handles

K-A Stopper Handles are machined to exacting standards, and give a pleasing appearance. They are machined from prime Beech or Birch, left in their natural condition with a smooth finish.

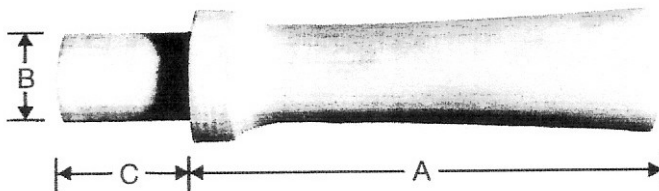

Order Details	A	B	C	Code	Order Details	A	B	C	Code
Stopper Handles 6"	1 1/8"	1 3/4"		FS652	Stopper Handles 2 9/32"	7/16"	13/16"		FS658
Stopper Handles 5 1/8"	1 "	1 1/2"		FS653	Stopper Handles 2"	3/8"	3/4"		FS659
Stopper Handles 4 3/8"	13/16"	1 5/16"		FS654	Stopper Handles 1 3/4"	5/16"	11/16"		FS660
Stopper Handles 3 11/16"	11/16"	1 3/16"		FS655	Stopper Handles 1 9/16"	1/4"	5/8"		FS661
Stopper Handles 3 1/8"	9/16"	1 1/16"		FS656	Stopper Handles 1 3/8"	7/32"	19/32"		FS662
Stopper Handles 2 11/16"	1/2"	15/16"		FS657	Stopper Handles 1 1/4"	3/16"	9/16"		FS663

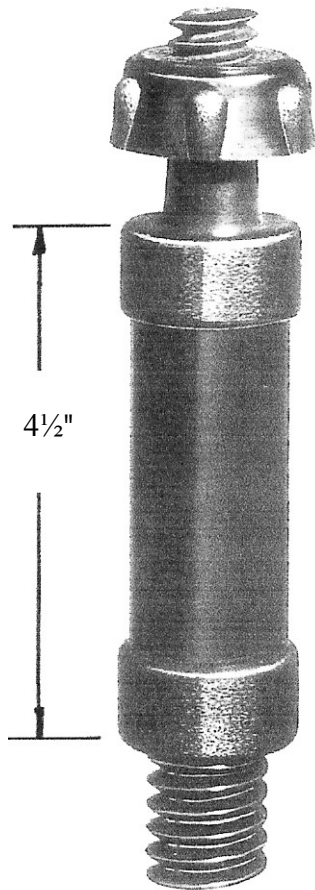

Rack Pillars

Moulded in black with a polished body and stippled ends to give an attractive appearance, they are tough and designed for life long service. Each Rack Pillar is supplied with a tough moulded nut, which has raised finger grips which also serve to fit an open ended wrench.

Rack Pillar taps are available to suit the threaded end.

Please note, other length pillars or configuration of ends to special order.

Order Details

Code

Rack Pillar 4 1/2" with Nut

FS547

Rack Pillar Tap

FS550

Silver Wire

This material is manufactured to the highest standards, and is subject to strict quality checks at all stages of production.

It is spring tempered solid silver wire, .015" dia. which is finally spin straightened. It is the material used in K-A Contact Blocks and is an ideal contacting material for all normal pipe organ applications.

Order Details

Code

Silver Contact Wire .015" dia.

GS110/09

Gold Clad Wire

Gold Is a malleable material and not capable of retaining a spring temper. Kimber Allen supplies 'Gold Clad' wire with the same degree of spring temper and straightness as the silver wire. This process should not be confused with gold plating. This specialised method allows pure gold to be rolled into a phosphor bronze core to form one solid rod. It is .015" dia. and is an ideal contacting material for switching small electrical currents. It is the material used in K-A Contact Blocks.

Order Details

Code

Gold Clad Wire .015" dia

GS109/02

Nickel Silver Wire

This material is specially made for bus bars where contact switching of low currents is required, it is .048" dia. and supplied in straight 36" lengths. Longer lengths cannot be supplied.

Order Details	Code
Nickel silver wire .048"dia.	GS104/07

Test Pins

These are headless 16 gauge steel pins pointed at one end, and finished in tin plate for ease of soldering. Applications are many and varied. Ideal for the connection of low voltage electrical cables.

Order Details	Code
Tinned Test Pins	FS559

P.V.C. Covered Copper Wire

This wire is ideal for general purpose installation wiring. The wire is 28 gauge copper with a PVC Cover and tin' coated for easy soldering at terminations Eleven colours are stocked to provide a complete colour coding system. Supplied in non returnable 500 metre coils.

Order Details	Code
P.V.C. 28g Wire Green	GS143/30
P.V.C. 28g Wire Violet	GS143/31
P.V.C. 28g Wire Blue	GS143/32
P.V.C. 28g Wire Pink	GS143/33
P.V.C. 28g Wire Red	GS143/34
P.V.C. 28g Wire Slate	GS143/35
P.V.C. 28g Wire Brown	GS143/36
P.V.C. 28g Wire White	GS143/37
P.V.C. 28g Wire Yellow	GS143/38
P.V.C. 28g Wire Orange	GS143/39
P.V.C. 28g Wire Black	GS143/40

Should a colour not be important order GS143/0.

Tinned Copper Braid

This is 1/4" wide flat braided tinned copper and is an essential item in connecting and earthing, with many and wide applications.

Order Details	Code
Tinned Copper Braid	FS558

Polyurethane Covered Copper Wire

This 28 gauge copper wire can be used for general purpose wiring, it does have the feature of a polyurethane coating and does not require stripping before soldering. It may also be used as a coil winding wire.

Order Details	Code
Polyurethane Copper Wire 28 gauge	GS143/41

Multi-Core Cable

Ideal for exposed wiring. Housed in a tough flexible outer casing, are 40 pairs of colour coded 28 gauge tin coated copper wire with a P.V.C. coating.

Coil length is 100 metres but shorter lengths can be supplied.

Order Details	Code
Multi-Core 80 Conductors	FS560

Non Adhesive Plastic Tape

A reel of this 1" wide black plastic tape is a useful item to carry. It has many applications, is non adhesive but will bond to itself.

Order Details	Code
Non Adhesive Plastic Tape	GS144/04

Phosphor Bronze Wire

Straight lengths of various diameters, an essential material for the Organ Builder is always available. Whilst 3 foot lengths is our standard, 6 foot lengths to special order can be supplied.

Order Details	Code
Phosphor Bronze Wire 19 gauge	GS105/19
Phosphor Bronze Wire 18 gauge	GS105/18
Phosphor Bronze Wire 17 gauge	GS105/17
Phosphor Bronze Wire 16 gauge	GS105/16
Phosphor Bronze Wire 15 gauge	GS105/15
Phosphor Bronze Wire 14 gauge	GS105/14
Phosphor Bronze Wire 13 gauge	GS105/13
Phosphor Bronze Wire 12 gauge	GS105/12
Phosphor Bronze Wire 11 gauge	GS105/11
Phosphor Bronze Wire 10 gauge	GS105/10

Green Felts

This felt is proofed for long life, and is made only from high quality pure wool.

Can be used in pallet production, gaskets, stops or wherever a high quality felt is required. Purchased from the 65" wide roll.

Order Details	Code
3mm Thick Green Felt	FS571
4mm Thick Green Felt	FS572

Brown Shutter Felt

This brown felt has many applications but is intended for use with shutters.

It is purchased from the 72" wide roll.

Order Details	Code
1/4" Thick Felt for Shutters	FS573

Grey Pedal Felt

This is a grey pedal felt can be used in many general applications.

It is purchased from the 72" wide roll.

Order Details	Code
1/2" Thick Felt for Pedals	FS574

Rubber Cloth

Pure rubber latex bonded to a pure cotton backing forms this Rubber Cloth. Two thicknesses are available, thin is approx. .007" thick and the thick is approx. .018" thick. Both are 60" wide and are purchased from the roll.

Using natural material the cloth will give a long and trouble free life.

Order Details	Code
Thick Rubber Cloth	FS566
Thin Rubber Cloth	FS567

Cork Sheets

This high quality cork is a general purpose item for making air seal gaskets and other applications. It can be glued in position or left to form its own seating. Available in sheet sizes of 3ft x 2ft.

Order Details	Code
Cork Sheet 1/32 " thick	FS568
Cork Sheet 1/16" thick	FS569
Cork Sheet 1/8" thick	FS570

Red Cloth

This is the highest quality pure wool red facing cloth, approx. 1 mm thick. Excellent in appearance and purchased from the 54" wide roll.

Order Details	Code
Red Cloth	FS587

Resin Cored Solder

This is a high quality solder in wire form with a central resin flux. Ideal for easy termination soldering.

Available in convenient 1/2kg drums.

Order Details	Code
Resin Cored Solder	FS586

Waxed Thread

This is a medium weight waxed linen thread and is ideal for cable tying and general purpose applications where a slightly heavier thread is required.

Order Details	Ref	Code
Waxed Thread, 250g reel	WT	FS561

Chest Brass

This is quality brass strip 7/8" wide x .024" thick supplied in coiled lengths with many and varied applications in earthing, conduction, and chest work. Purchased in coils to required length.

Order Details	Code
Chest Brass	GS 102/02

Bedding Tape

Grey foam bedding tape adhesive on one side 25mm wide x 1.5mm thick on 50mt coil.

Order Details	Code
Bedding Tape	FS592

Red Thread

This is a very strong lightweight 3 ply red thread which has been used for many years. Has many uses and is a very reliable general purpose servicing material.

Order Details	Ref	Code
Ref Thread , 50g reel	RT	FS278

Colloidal Graphite

Colloidal Graphite, the traditional lubricant in organ building, cannot be surpassed, and is an ideal medium in all environments. Supplied in convenient 1 litre tins.

Order Details	Code
Colloidal Graphite	FS588



Combined Springs and Wipers

As used on the K-A timber constructed keyboards.

Order Details	Ref	Code
Combined Springs & Wipers	CSW	FS102

K.A Mechanical Action System

The KIMBER-ALLEN Mechanical (Tracker) parts ,offers to the Organ Builder a complete system with many variables to suit all types of installations. The parts have the quality and reliability and design to enhance the craft of the user.

The Roller Board assembly using the K-A method is unique, in its space and labour saving approach to a time consuming operation. A suggested method of Roller Board assembly is illustrated on page 66. Normally in practice a time saving of around 40% should be achieved.

The Tracker linkage in principle falls into the following three methods.

On page 60 are Roller Arms and Squares manufactured to accommodate the conventional conical stainless Pivot Pin. This method gives a totally frictionless action with the use of circular or rectangular linkage.

On pages 61 & 62 are Bushed Roller Arms and Squares, here one has a choice of either standard circular bushes or the K-A Special removable bushes. Again either circular or rectangular trackers provide the linkage.

On page 63 are Special Roller Arms and Squares manufactured to accommodate the Tracker Wire End Clips. Although Intended for use with 2mm dia Aluminium Wire for a positive and fast method of assembly, other forms of linkage can be used.

As the system is interchangeable it is quite normal for a combination of these three methods to be used.

We supply Rectangular and Circular Fibre Glass as an alternate tracker material, it is very useful in difficult environments and for the many builders who prefer an inert material. However we stress that all our tracker endings are designed to be used on builders own wooden trackers.

The K-A System is compatible with existing standard systems and therefore can be used in repairs and reconstructions.



Pivot Pins

Polished Pivot pins 9mm long x 1.8mm dia. Manufactured from -13% content stainless steel and hardened to 55 Rockwell for long rust proof life.

These pivots are used in the K-A range of Mechanical Parts. Supplied in quantities of 500 for the Organ Builders specialist application.

Order Details

Code

Pivot Pins

FS700

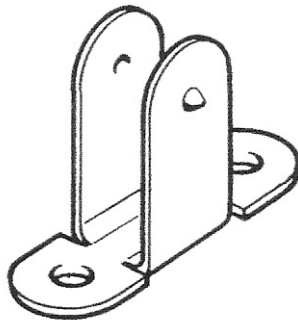

Pivot Support Fixed

Manufactured from Nickel Plated Hardened Brass. The uprights are overformed to provide spring retention of the pivot pin in coined indentations to give freedom of movement with maximum security. Base with two 3mm dia. holes for screws or pop rivets, flattened over entire area for rigid and square fixing.

Order Details

Code

Pivot Support Fixed

FS701

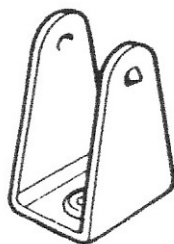

Pivot Support Plain

Generally as Part No. 701, above with one central 4mm dia. hole in base.

Order Details

Code

Pivot Support Plain

FS702

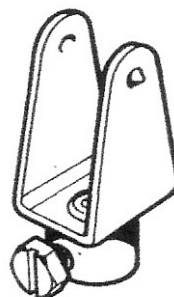

Pivot Support with Locking Collar

As part No. 701 with the addition of an aluminium collar, 5mm long x 7mm dia. riveted to base. This collar has a 2.7mm dia. bore and can be fitted with hexagon headed screw or high tensile scrub screw. Please state preference when ordering.

Order Details

Code

Pivot Support Locking Collar
State Hex or Grub.

FS703

Locking Collar

Aluminium Collar 7mm dia, x 7mm long with 2.7mm dia. bore, domed end for smooth action. Can be fitted with hexagon headed screw or high tensile grub screw. Please state preference when ordering.



Order Details

Code

Locking Collar
State Hex or Grub

FS704

Adjuster Locking Collar

Body manufactured from hard aluminium with 2.7mm dia. bore with domed end, screwed to body to give approx. 6mm of adjustment. To facilitate use the plastic adjuster has raised finger grips. Can be fitted with hexagon headed screw or high tensile grub screw. Please state preference when ordering.



Order Details

Code

Adjuster Locking Collar
State Hex or Grub.

FS705

Roller Bracket with Bush

Manufactured from Nickel Plated Hardened Brass. Designed for use with the K-A removable bush, supplied with a choice of a white moulded or felt lined yellow bush. Both give free movement on the end spindle of K-A special roller arms and compatible systems using 2mm dia. spindles. Please refer to the drawing on page 66 showing the K-A Roller System, for operation and layout procedures of this bracket. Please state choice of bush when ordering.

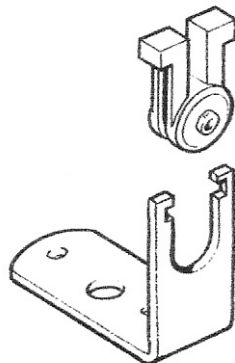

Order Details

Code

Roller Bracket with bush
State White or Yellow.

FS706

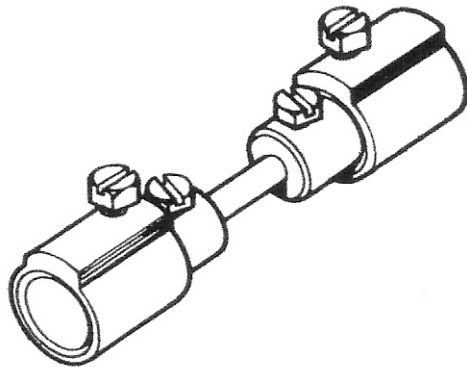

Roller Connector Assembly

Manufactured from hard aluminium extrusion it is used to give support to long 8mm dia. rollers. The Nickel Plated centre spindle has flats to engage on the centre screws for positive drive. These screws can be 'lost' by insertion in the alternative position in rear. Included is the special K-A removable bush, used with Bracket FS706.

Order Details

Code

Roller Connector Assembly

FS707

Removable Bush

The K-A Moulded Removable Bush is unique in its application to roller arms, squares, etc. It provides ease of assembly with the facility of removing the bush for repair or modification. Once seen its application is readily appreciated by the user. The bores, as listed below, have a 20° inclusive angle at each end to give 1.5mm of parallel in centre of the bush giving a very free action. Please state colour required.

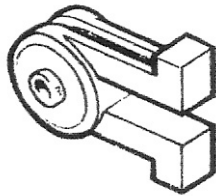

Red	1.75mm bore
White	2.05mm bore
Black	2.50mm bore
Yellow (felt bushing)	2.05mm bore

Order Details

Code

Removable Bush

FS708

State Red, White, Black or Yellow.

Standard Bush

Supplied for those applications when the standard type of bush is required. The moulding is compatible with existing systems and has the same angular and colour coding (with the exception of yellow) as part No. FS708. Please state colour required.



Order Details

Code

Standard Bush

FS709

State Red, White or Black.

Tracker Connector

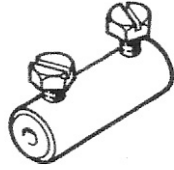

Aluminium alloy connector 19mm long and bored 2.7mm dia. to join 2mm dia. tracker wires. Can be supplied with hexagon headed screw or grub screw. Please state preference when ordering.

Order Details

2mm dia. Tracker Connector
State Hex or Grub.

Code

FS710

Tracker Wire End Clip

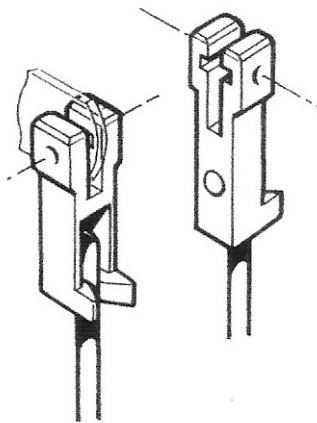

This item is moulded in quality plastic to accept 2mm dia. Aluminium Tracker Wire FS744. The pivot end will clip to special K-A roller arms FS722 and FS723, K -A intermediate roller arms FS810 and FS811 and K-A squares FS739 and FS740.

This arrangement provides a simple, removable connection between tracker wires, arms and squares.

Order Details

Tracker Wire End Clip

Code

FS711

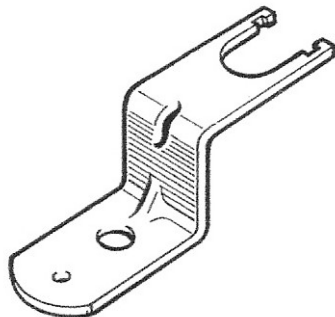

Stand Off Bracket

Manufactured from Nickel Plated Hardened Brass, engineered to use the K-A removable bush. It has been designed for use with suspended actions, but has many other applications.

Order Details

Stand Off Bracket

Code

FS724

Tracker Ends

These three terminations, moulded in high quality plastic, for use with either 2mm dia. Aluminium Wire or Fibre Glass provide the same selection as the Tracker Ends FS830 to FS835.

They are supplied with two self tapping screws which bite into the tracker material for extra security. They are light, easily fitted and will speed up assembly to K-A Roller Arms and Squares.

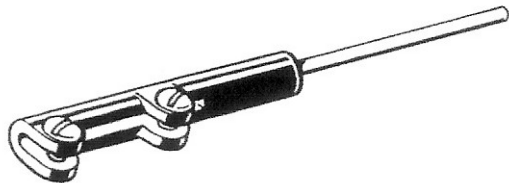

1 1/4" of 2mm dia. aluminium for users own preparation and in particular for hook up to the Tracker End Clip FS711.

Order Details	Code
Plain Tracker Wire End	FS840

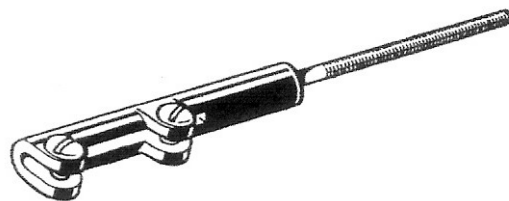

1 1/4" of 2mm dia. nickel plated phosphor bronze rolled thread.

Order Details	Code
Threaded Tracker Wire End	FS841

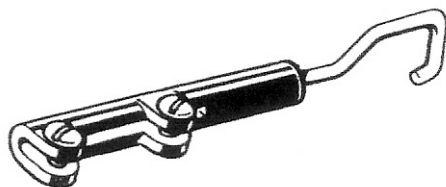

This 2mm dia. nickel plated phosphor bronze hook is designed to be used with either the white standard bush FS709, or the white removable bush FS708. These bushes can be slipped into the hook and in use gives free movement without lost motion.

Order Details	Code
Hook Tracker Wire End	FS842

Moulded in quality black plastic to complement the white fibreglass trackers. The design permits a fast and permanent fixing which can be removed if required by means of the self tapping screw supplied. Easy insertion of the screw is either by drilling or hand piercing using the Tracker End as a guide, the lower hole is for visual check of correct assembly of the tracker. K-A Tracker Ends can be used on any tracker material, wood or fibreglass.

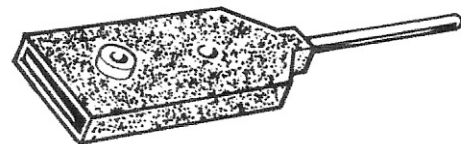

1 1/4" of 2mm dia. Aluminium for users own preparation, and in particular for hook up to the Tracker End Clip FS711.

Order Details	Code
Plain End for 8 x 1.3mm trackers	FS830
Plain End for 11 x 1.8mm trackers	FS831

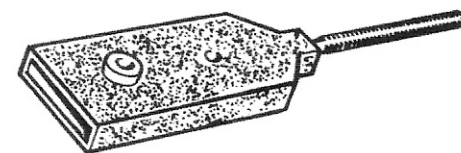

1 1/4" of 2mm dia. nickel plated phosphor bronze, rolled thread.

Order Details	Code
Threaded End for 8 x 1.3mm trackers	FS832
Threaded End for 11 x 1.8mm trackers	FS833

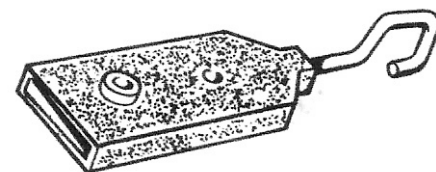

This 2mm dia. nickel plated phosphor bronze hook is designed to be used with either the white standard bush FS709, or the white removable bush FS708. These bushes can be slipped into the hook and in use gives free movement without lost motion.

Order Details	Code
Hook End for 8 x 1.3mm trackers	FS834
Hook End for 11 x 1.8mm trackers	FS835

Pivoted Ends

These Roller Arms, intermediate Arms and Squares are fitted with the conical hardened stainless Pivot Pins FS700. By fitting Pivot Supports FS703 to the pivots, either 2mm dia. tracker materials can be used direct, or conversion to rectangular tracker can be made by selecting the correct size of Tracker Ends FS830 or FS831.

Roller Arms

These Roller Arms cap each end of the roller and provide the end bearing in the Roller Bracket FS706.

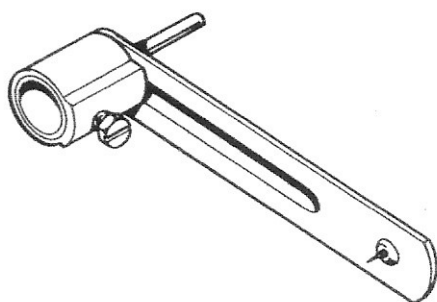

Order Details

Code

50mm Roller Arm

FS712

70mm Roller Arm

FS713

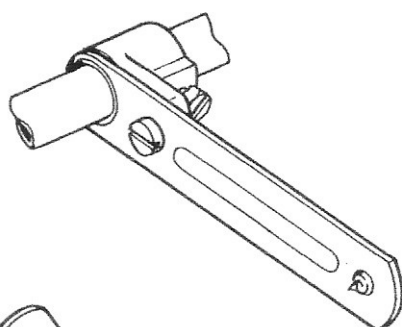

Intermediate Arms

These Intermediate Roller Arms can be fitted at any position along the roller.

Order Details

Code

50mm Intermediate Arm

FS800

70mm Intermediate Arm

FS801

Note: When current stocks of intermediate arms are exhausted this line will be discontinued.

Squares

These Squares have the hardened conical stainless Pivot Pin FS700 fitted at the junction of the two arms and require a Fixed Pivot Support FS701.

Order Details

Code

50mm Square

FS725

70mm Square

FS726

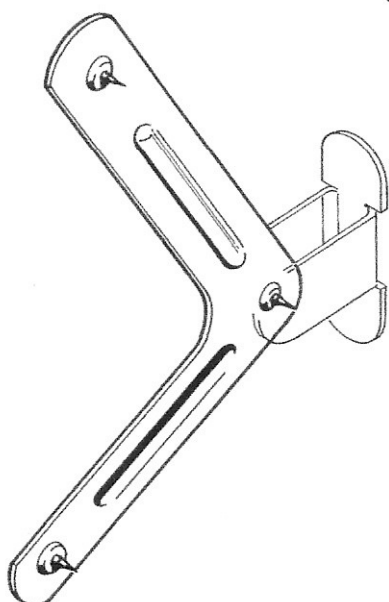

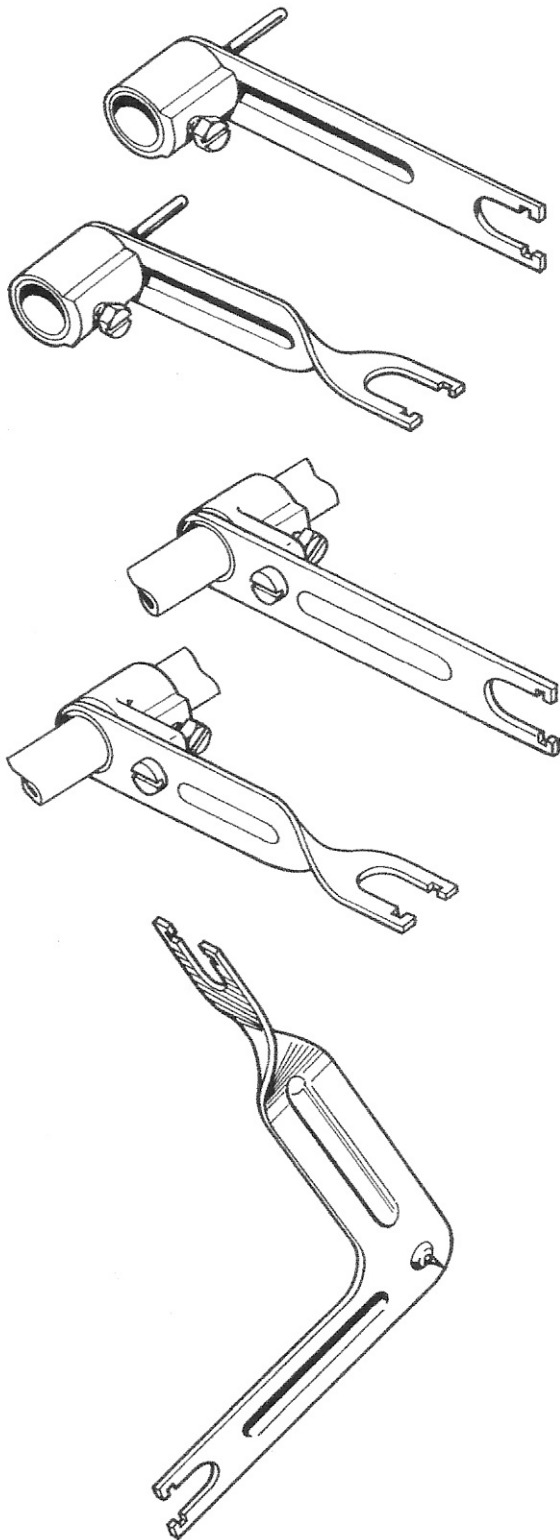

KA Removable Bushing

These Roller Arms, Intermediate Arms and Squares are designed to accept the K-A range of Removable Bushes FS708. This arrangement provides the unique facility of bush removal. Once the selected bush is inserted either 2mm dia. tracker materials can be used direct by using Locking Collars FS704 and Adjusters FS705. Other tracker materials can be used by selecting a suitable K-A Tracker Ending.

Roller Arms

These Roller Arms cap each end of the roller and provide the end bearing in the Roller Bracket FS706.

Order Details

Code

Straight Arm 50mm	FS714
Straight Arm 70mm	FS715
Twisted Arm 50mm	FS716
Twisted Arm 70mm	FS717

Intermediate Arms

These Intermediate Roller Arms can be fitted at any position along the roller.

Order Details

Code

Straight Arm 50mm	FS802
Straight Arm 70mm	FS803
Twisted Arm 50mm	FS804
Twisted Arm 70mm	FS805

Note: When current stocks of intermediate arms are exhausted this line will be discontinued.

Squares

These Squares have the hardened conical stainless Pivot Pin FS700 fitted at the junction of the two arms and require a Fixed Pivot Support FS701.

Leg Types

Order Details

Code

Both Straight 50mm	FS727
Both Straight 70mm	FS728
Straight and Twisted 50mm	FS729
Straight and Twisted 70mm	FS730
Both Twisted 50mm	FS731
Both Twisted 70mm	FS732

Standard Bushing

These Roller Arms, intermediate Arms and Squares are designed to accept the traditional circular Standard Bushes FS709, Apart from this change, the same remarks apply as the K-A Removable Bush range.

Roller Arms

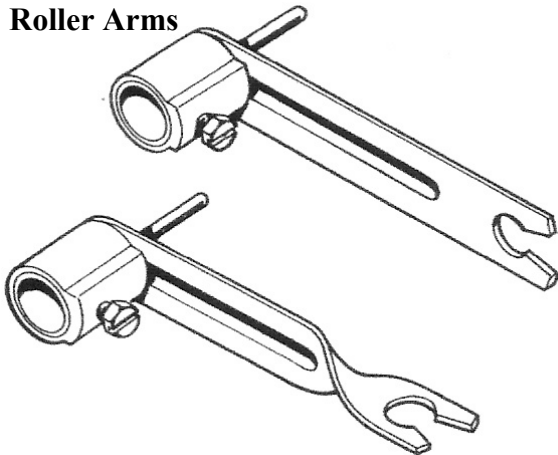

Roller Arms

These Roller Arms cap each end of the roller and provide the end bearing in the Roller Bracket FS706.

Order Details

Code

Straight Arm 50mm	FS718
Straight Arm 70mm	FS719
Twisted Arm 50mm	FS720
Twisted Arm 70mm	FS721

Intermediate Arms

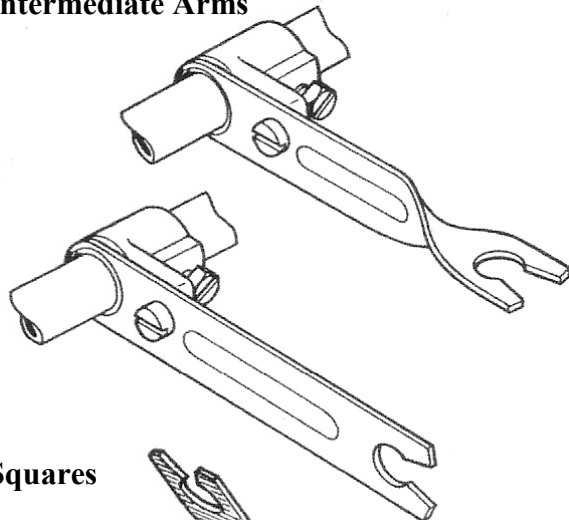

Intermediate Arms

These Intermediate Roller Arms can be fitted at any position along the roller.

Order Details

Code

Straight Arm 50mm	FS806
Straight Arm 70mm	FS807
Twisted Arm 50mm	FS808
Twisted Arm 70mm	FS809

Note: When current stocks of intermediate arms are exhausted this line will be discontinued.

Squares

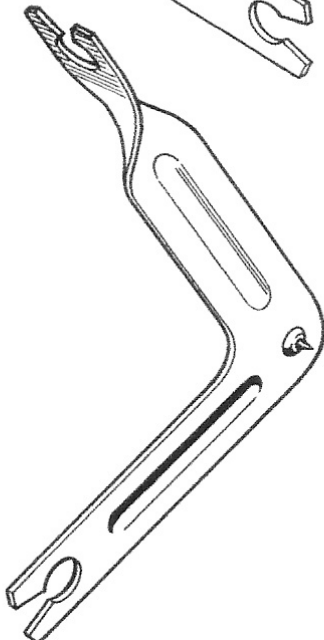

Squares

These Squares have the hardened conical stainless Pivot Pin FS700 fitted at the junction of the two arms and require a Fixed Pivot Support FS701.

Leg Types

Order Details

Code

Both Straight 50mm	FS733
Both Straight 70mm	FS734
Straight and Twisted 50mm	FS735
Straight and Twisted 70mm	FS736
Both Twisted 50mm	FS737
Both Twisted 70mm	FS738

Tracker Wire End Clip

These Roller Arms, Intermediate Arms and Squares are specially designed to accept only the unique Tracker Clip FS711. This design gives a fast method of linking 2mm dia. aluminium tracker wire, and also by selecting a suitable Tracker End FS840, FS830 or FS831, a wide range of applications can be made. The Tracker Clip as its name implies can be clipped into position or removed as required. Attachment of the aluminium wire to the clip is fast and simple. The precision mounting of the Tracker Clip to the spindle inserted in the Roller Arm and Square ends gives a frictionless action.

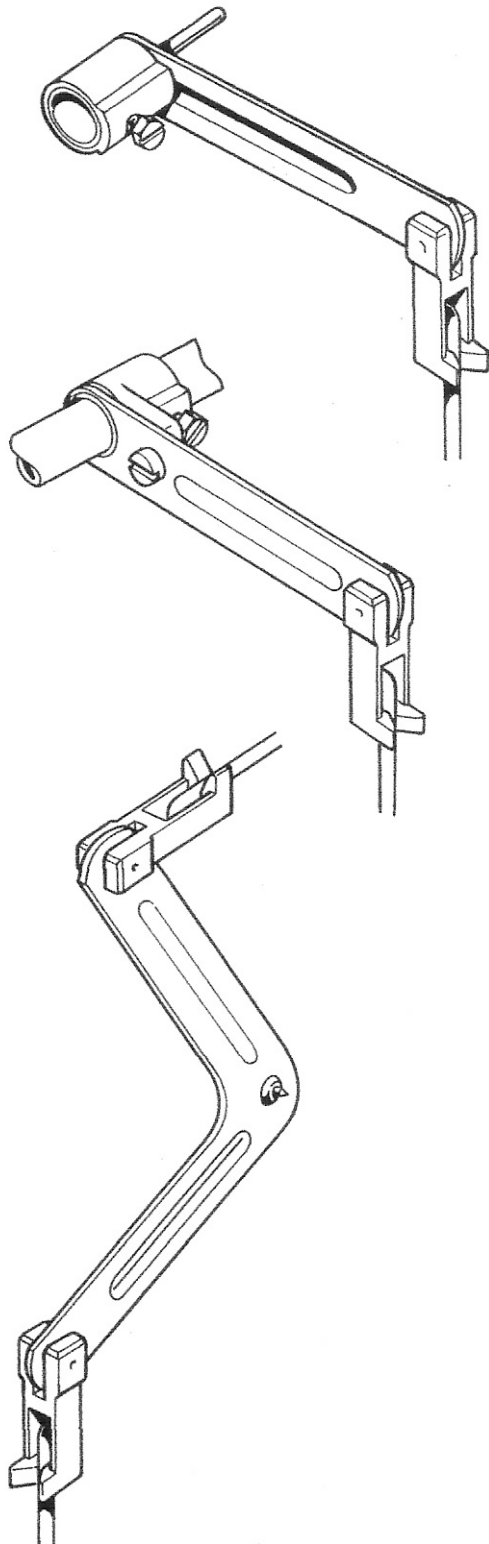

Roller Arms

These Roller Arms cap each end of the roller and provide the end bearing in the Roller Bracket FS706.

Order Details

Code

50mm Roller Arm

FS722

70mm Roller Arm

FS723

Intermediate Arms

These intermediate Roller Arms can be fitted at any position along the roller.

Order Details

Code

50mm Intermediate Arm

FS810

70mm Intermediate Arm

FS811

Note: When current stocks of intermediate arms are exhausted this line will be discontinued.

Squares

These Squares have the hardened conical stainless Pivot Pin FS700 fitted at the junction of the two arms and require a Fixed Pivot Support FS701.

Order Details

Code

50mm Square

FS739

70mm Square

FS740

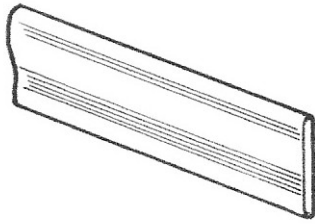

Rectangular Trackers

Manufactured in White Fibreglass. it has high strength, is unbreakable, is inert and gives no harmonic ring. Sizes are compatible with existing systems.

Order Details

Code

Rectangular Tracker 11 x 1.8mm

FS821

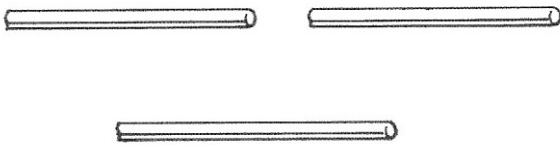

Tracker Wires Fibre Glass

Fibre Glass

Fibre Glass an inert material with high tensile strength and extreme lightness without harmonic ring.

Order Details

Code

2mm dia. Fibreglass

FS745

Aluminium

Aluminium is a suitable alloy which provides sufficient stiffness for an efficient action of malleability for the user to form ends if necessary.

Order Details

Code

2mm dia. Aluminium

FS744

Phosphor Bronze

Phosphor Bronze for the specialist application.

Order Details

Code

2mm dia. Phosphor Bronze

FS746

Aluminium Rollers

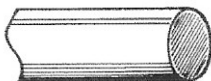

Solid

Solid 8mm dia. Aluminium Alloy Rod, for use in the K-A Roller System for heavy actions or where a long, unsupported roller requires high resistance to torsional strain. Can also be used for any fixings in compatible roller systems.

Order Details

Code

Solid Roller

FS742

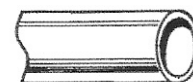

Tube

Aluminium Alloy Tube 8mm dia x 6mm bore for use with K.A Roller Arms and compatible items. When assembled this alloy is rigid with good resistance to torsional strains. Ideal for the manufacture of light weight and sensitive roller systems.

Order Details

Code

Roller Tube

FS743

Roller Screws

The Roller Screw is specially manufactured to K-A design to securely lock into position all K-A Roller Arms, intermediate Roller Arms and Roller Connectors.



Manufactured in quality steel Nickel Plated, robust thread of 3.5mm dia. with internal cone for security fixing to Rollers.

Order Details	Code
Roller Screws	FS747

Collar Screws

The Collar Screw is similar in design to the Roller Screw. The hexagon head having a screwdriver slot for initial setting and the 2.5mm thread has an internal cone for positive fixing to K-A Tracker Wire fittings.



Order Details	Code
Collar Screws	FS748

Grub Screws

The Grub Screw provides an alternative to the Collar Screw for close pitching of Tracker Wires, and is manufactured from high tensile steel for positive fixing and reliability. Hexagon keys are supplied free of charge.



Order Details	Code
Grub Screws	FS749

Nut Driver

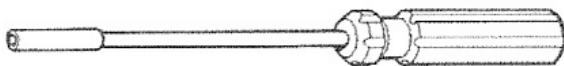

The Nut Driver is suitable for both types of K-A screw it can also be used with compatible fittings. Being 9" long it can be used for the difficult to get at areas. The front end has been reduced in diameter for use on close pitch work.

Order Details	Code
Nut Driver	FS750

Opening Pliers

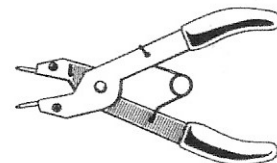

The opening pliers will prevent damage to the ends of pivot pins and the inner faces and coined seatings of Pivot Supports during assembly of Roller Arms and Squares.

Order Details	Code
Opening Pliers	FS751

The K-A Roller System

The K-A Roller System provides a simple, cost effective, method of building up roller boards of high quality.

The Pin Hole "A" in the Roller Bracket indicates the position of the Roller Arm on the final assembly.

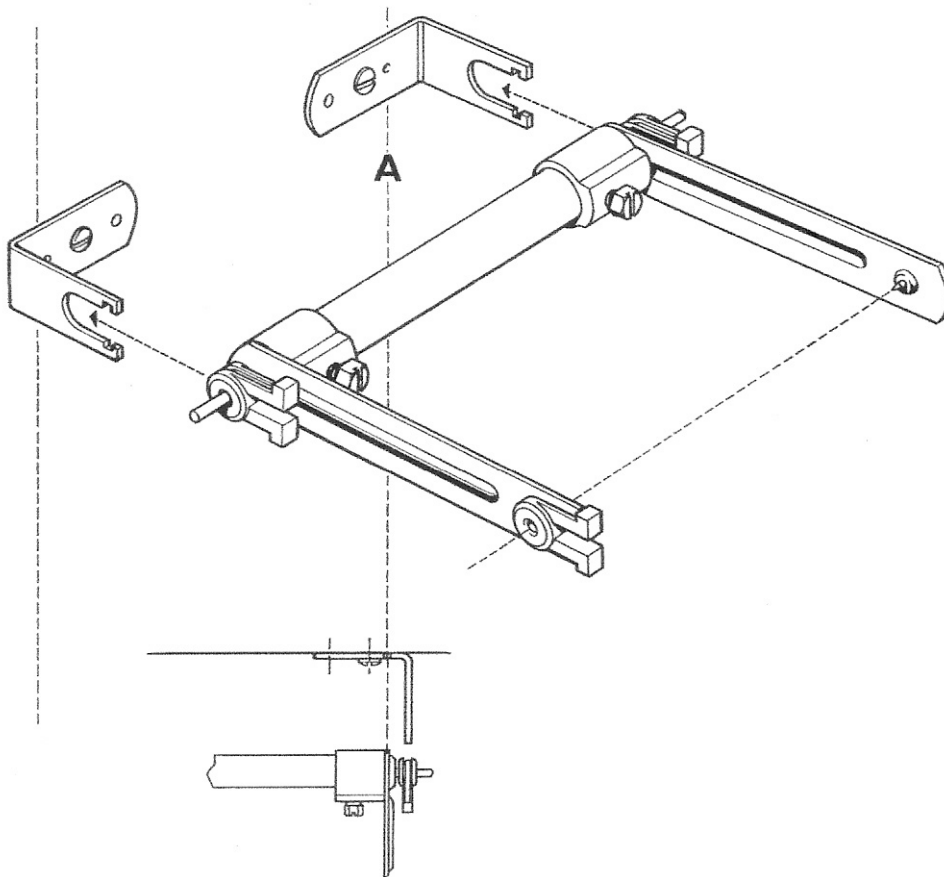

Suggested Method of Assembly

1. Position brackets - hole "A" to tracker wire positions.
2. Pin and screw brackets to roller board.
3. Make loose assembly of:-
Roller tube cut to length Roller arms and Intermediate arms,
selected type K-A removable bush - White all plastic or Yellow felt
bushed.
4. Clip to brackets, Squeeze bush legs to insert or remove.
5. Lock roller arm screws after positioning arms.

THIS PAGE IS INTENTIONALLY BLANK

Dedham Diode System



The long standing diode switching system is still being produced by Dedham Organ Systems and is still very much in demand.

This system is a series of electronic 'AND' gates using discrete components, i.e. resistors, diodes and transistors.

There has been little changed on the design of this system over the last 20 years, the last changes being in the elimination of Polysol wire replacing it with p.v.c. cable making for a more robust system. Now each manual has its own unique colour within the system making it far easier to trace any problems should they ever occur.

The circuit boards are all pre-wired to a common pinboard eliminating the need for the organ builder to connect directly to the circuit boards. This pinboard requires just a single wire from each key, pedal and stop contact. All pipe magnets are cabled through to their respective terminal pin. All printed circuit boards are mounted on hinged mahogany frames for easy access should ever the need be required.

Standard polarities apply with all inputs switching to the 12-18 volt Positive terminal of the power supply unit.

With all outputs being Negative, all magnets driven from the system require their return (busbar) wires connected to the Positive terminal of the power supply unit..

Should your preference still be for the Diode system, why not ask us to quote for your requirements.

Dedham 2Wire Processor System

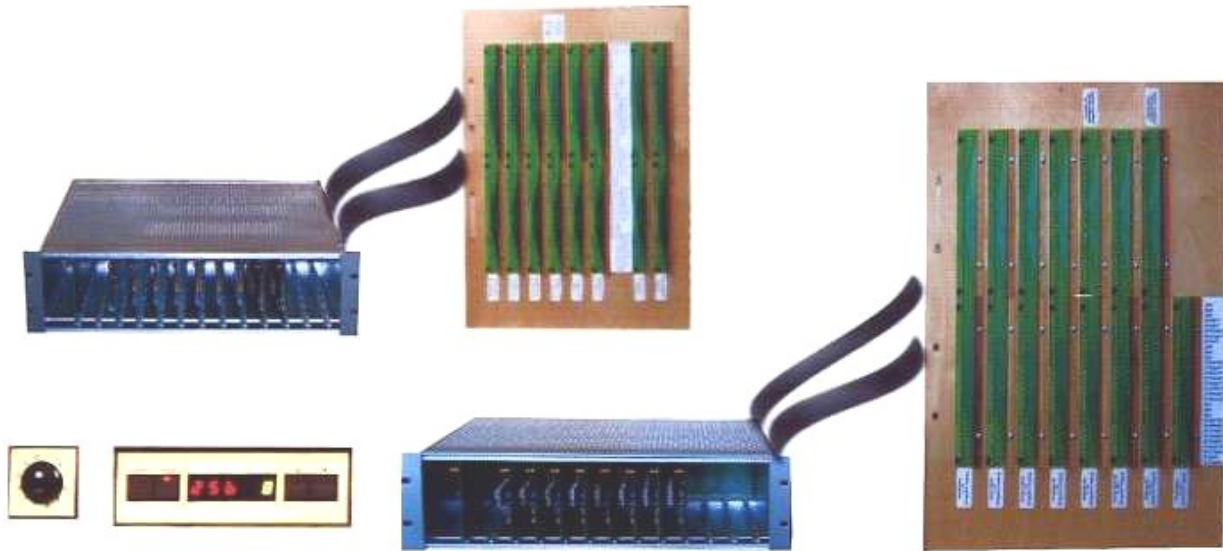

The Dedham system has been designed as a complete keying and piston memory system for use when a detached console is required. Individual modules are eliminated in this all in one system simplifying installations and without the need for those “special tools” being required.

This system comes completely programmed for all functions as required, eliminating the need for the Customers to ‘self programme’.

The piston memory extends from a simple 12 way rotary switch system, to a 30 or 60 level display module, and up to 256 levels for general piston, along with the 12 way for department levels, this is primarily for use when a stepper is required when the current general piston number is displayed.

The organ receiver system is completely programmed for all stop-note unifications as required, with action cut-outs, and top, and off notes fully incorporated.

This system can also be built as an all in one unit, where inputs and outputs are incorporated into the one case, often resulting in a substantial saving.

The PCB pinboard can either be our standard pin termination or supplied with ‘Krone connectors’ and if required with smt light emitting diodes.

Economical Switched Piston Selector Panel

A simple slide switch piston stop selector for those smaller instruments when a multi-level memory system is not required. Reversables wire in as required.

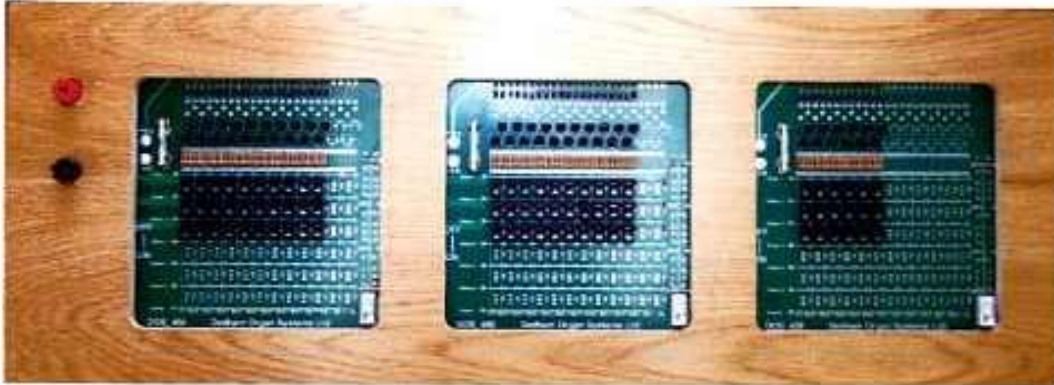

Pedal Derivation Driver Panel

For those occasions when a simple switching module is all that is required for those Pedal units.

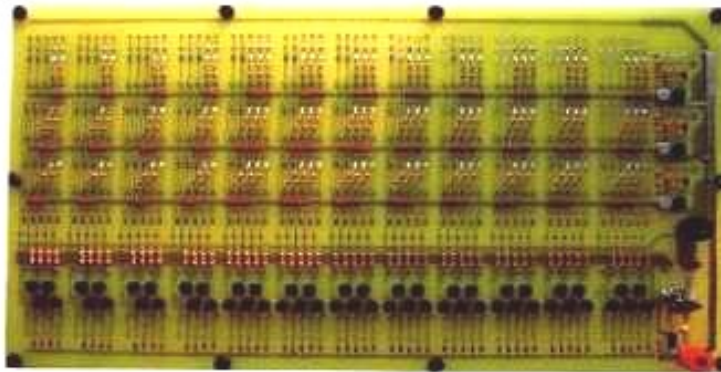

Melodic Bass Unit Panel

For that occasion when your client requires the function of playing the lowest pedal note from the Manuals.



In all of the above all standard polarities apply.

Should you require any further information on any of the above systems please contact us for in depth details.

THIS PAGE IS INTENTIONALLY BLANK

Electric Action Wooden Keyboard



General information

- ⇒ Wooden construction keyboards.
- ⇒ Natural keys covered in synthetic ivory bevelled 'bird beak' profile.
- ⇒ Combined spring & wiper action.
- ⇒ Available as bare keyboard or fitted with cheeks, slips & action as required.
- ⇒ Range of sharps-Polished black plastic as standard-Ebony-Rosewood.
- ⇒ Range of key checks & slips-Mahogany-Oak-Walnut.

Please contact Kimber-Allen with exact specification to obtain price.

Keyboard Action



Keyboard
Front Stop



Standard Action Components

Code	Ref.	Order Details	See Page No.
FS102	CSW	Combined Spring and Wiper.	53
FS311	KH	Key Hook 12g.	41
FS313	KCW	Key Check Wire.	41
FS279	RCW/2	Red Cloth Washers.	38
FS273	PBM/15	Plastic Buttons medium 15g.	38
		Long Silver Contact Assemblies as required.	11
		Sets of Miscellaneous Fittings:-	
		3 x Brown felt washers	
		2 x Wood screws	
		1 x Metal washer	

BELLOWS**SINGLE RISE
BELLOWS****NEW BELLOWS**

Ref.	Description of item	Code
Single rise	3 x 2	WS100
	3 x 3	WS101
	4 x 3	WS102
	4 x 4	WS103
	5 x 4	WS104
	5 x 5	WS105
	6 x 4	WS106
Double rise	3 x 3	WS107
	3 x 4	WS108
	4 x 4	WS109
	5 x 4	WS110
	5 x 5	WS111
	6 x 4	WS112
* Bellows finishing (Painting etc)		
Concussions	24" x 12"	WS113
Bellows relief pallet	8" x 4"	WS114
Primary action	3" x 1" (61 off)	WS115
Motors (Unribbed)	12" x 2" (61 off)	WS116
	3" x 1" (1 off)	WS117
	12" x 2" (1 off)	WS118

Note: Ribbed action motors can be re-leathered

RELEATHERING OF BELLOWS

Ref	Description of item	Code
Single rise	3 x 2	WS200
	3 x 3	WS201
	4 x 3	WS202
	4 x 4	WS203
	5 x 4	WS204
	5 x 5	WS205
	6 x 4	WS206
Double rise	3 x 3	WS207
	3 x 4	WS208
	4 x 4	WS209
	5 x 4	WS210
	5 x 5	WS211
	6 x 4	WS212
Concussions	24" x 12"	WS213